

FunSicle®

3D Fun QuickSet® Pool

Most immersive way to water play

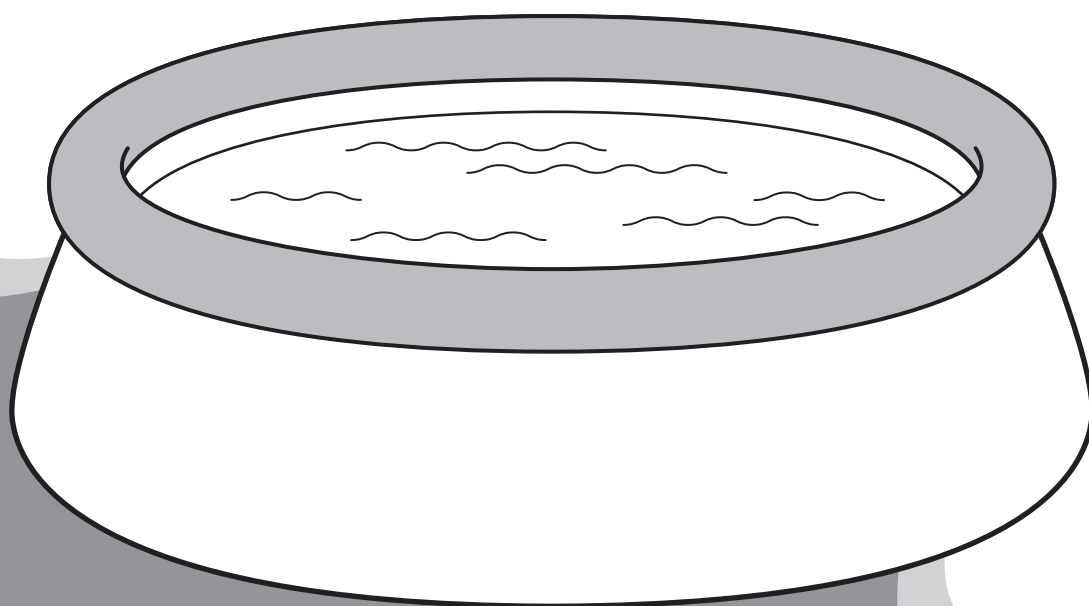

User Guide

Simple steps to setting up and enjoying your pool

Contents

Welcome!	3
Warranty Information	3
Safety Guidelines	4
Location Requirements	4
Warnings	4
Pool Safety Sign	10
Pool Ladder Safety	10
Pool Cover Safety	11
Building Your Pool	12
Inside Your Product Box	12
STEP 1: Prepare the Site	13
STEP 2: Lay out the Liner	13
STEP 3: Inflate the Top Ring	14
STEP 4: Install the Fittings for Filter Pump	14
Filling Your Pool	15
Draining & Dismantling Your Pool	17
Maintaining Your Pool	18
Storage	18
Repair	18
Winterizing	19
Using Your 3D Goggles	20

Welcome!

Congratulations on your new Funsicle 3D Fun QuickSet Pool – the most immersive way to water play. This guide will walk you through everything from setting up to maintaining and enjoying your pool.

Model No.: P10F08300

Warranty Information

This Funsicle 3D Fun QuickSet Pool is subject to the following warranty, with warranty service provided by Polygroup Pacific Limited (hereinafter "Polygroup").

Limited Warranty

Polygroup is pleased to offer this warranty for the repair or replacement of Above Ground Pools for one (1) year from the date of purchase. The provisions of this Limited Warranty only apply to the original purchaser and who purchased from an authorized Polygroup seller. Please keep your original store sales receipt. This proof of purchase will be required and must accompany warranty claims to Polygroup or its designated agents. This Limited Warranty will not apply to modified or repaired products, unless authorized by Polygroup in writing; or to products in which non-Polygroup parts or accessories were substituted; or use of the product in contravention of the product's instructions; or when improper voltage was used; or if the product was abused, or harmed through accident or negligence. This Limited Warranty does not cover consequential damages, including, but not limited to, claims for loss of water, pool chemicals, or labor time or costs, normal wear-and-tear; nor to acts of God, nor to damage to any other products or property.

In no event shall Polygroup, its authorized agents, related entities, or employees be liable to the buyer or any other party for direct or consequential damages. This limitation, in part or in full, may not apply to you, if the jurisdiction in which the claim arose does not allow this limitation.

This Limited Warranty is not extended to close-outs, factory seconds, or resold products, such as garage sales or auctions, or purchases from non-authorized sellers of Polygroup products. This Warranty also does not apply to online vendors or any other sellers who did not purchase the products from a Polygroup company, whether the product has been used or not prior to being sold to you. Any issues with items purchased from these types of vendors/sellers will need to be addressed directly with them.

Safety Guidelines

IMPORTANT SAFETY INSTRUCTIONS

When installing and using this product, basic safety precautions should always be followed, including the following:

READ AND FOLLOW ALL INSTRUCTIONS

Failure to follow these warnings and instructions can result in serious injury or death.

Location Requirements



- Set up the pool only on level, flat, stable, and compact soil.
- Remove sharp objects from the ground that may puncture the pool (e.g. hardy grasses, stones, loose nails, twigs, etc.)
- Do not set up the pool on sand or concrete surfaces.
- Excessive sand inside the pool will damage the pool liner and filtration system.

Failure to follow these instructions will void the warranty.

NOTICE: Customers who purchase pools may be required by local or state law to incur additional expenses when installing a pool, in order to comply with state or local laws regarding fencing and other safety requirements. Customers should contact their local building code enforcement office for further details. Polygroup is not responsible for any additional expenses that you may incur.

Warnings



WARNING!

To prevent drowning, this pool must have a barrier such as a 1.2m high fence surrounding the pool. The barrier must comply with the Building Code and restrict unsupervised access by children under 5 years of age. For more information visit www.building.govt.nz/poolsafety

WARNING!
CHILDREN HAVE DROWNED IN PORTABLE POOLS. ENSURE ACTIVE ADULT SUPERVISION AT ALL TIMES. DO NOT LEAVE CHILDREN UNSUPERVISED IN OR AROUND THE POOL—KEEP THEM WITHIN ARMS’ REACH. EMPTY AND STORE SAFELY WHEN NOT IN USE.

 WARNING				
PREVENT DROWNING! Watch children at all times. Follow all safety rules. 	NO DIVING! NO JUMPING! Shallow Water – You can be permanently injured. 	DO NOT SIT ON OR LAY OVER POOL WALL You can be permanently injured. 	AVOID ENTRAPMENT! Stay away from suction fittings. You may drown. 	
				
Please read carefully and keep for future reference				

Carefully read, understand, and follow all information in this user manual before installing and using the swimming pool. These warnings, instructions, and safety guidelines address some common risks of water recreation, but they cannot cover all risks and dangers in all cases. Always use caution, common sense, and good judgment when enjoying any water activity.

NON-SWIMMERS SAFETY

- Continuous, active, and vigilant supervision of weak swimmers and non-swimmers by a competent adult is required at all times (remembering that children under 5 years old are at the highest risk of drowning);
- Designate a competent adult to supervise the pool each time it is being used;
- Weak swimmers or non-swimmers should wear personal protective equipment (PPE) when using the pool;
- When the pool is not in use, or unsupervised, remove all toys from the swimming pool and its surrounding to avoid attracting children to the pool.
- When the pool is not in use, remove all toys and other objects from its surroundings, including those that could be used by a child to facilitate access into the pool (such as chairs, big toys, etc.).

SAFETY DEVICES

- Barriers, pool covers, pool alarms, or similar safety devices are helpful aids, but they are not substitutes for continuous and competent adult supervision.

SAFETY EQUIPMENT

- It is recommended to keep rescue equipment (e.g. a ring buoy) by the pool;
- Keep a working phone and a list of emergency phone numbers near the pool.

SAFE USE OF POOL

- Encourage all users especially children to learn how to swim;
- Learn Basic Life Support (Cardiopulmonary Resuscitation – CPR) and refresh this knowledge regularly. This can make a life-saving difference in the event of an emergency;
- Instruct all pool users, including children, what to do in case of an emergency;
- Never dive into any shallow body of water. This can lead to serious injuries or death;
- Do not use the swimming pool when using alcohol or medication that may impair your ability to safely use the pool;
- When pool covers are used, remove them completely from the water surface before entering the pool;
- Protect pool occupants from water-related illnesses by keeping the pool water treated and practising good hygiene. Consult the water treatment guidelines in the user's manual;

- Store chemicals (e.g. water treatment, cleaning or disinfection products) out of the reach of children;
- Removable ladders shall be placed on a horizontal surface (if applicable).
- Find an appropriate location to prevent the hazard of drowning of young children, install the pool in a place where it is possible for the supervision to be constant.
- Replace water regularly according to the manufacturer's recommendations, as well as based on the water's hygiene conditions, cleanliness, clarity, odor, and if any debris or stains are present in the pool. Use of chemicals in a pool without water circulation may result in an individual coming in direct contact with the chemicals, such as in areas of the pool with a high chemical concentration, resulting in injury to the user.
- If chemicals are occasionally used to reduce the frequency of water replacement, follow the chemical manufacturer's instructions closely (make sure to never use more than the recommended amounts stated), and ensure chemicals are mixed appropriately to avoid personal injuries. Store chemicals out of reach of children.
- The use and installation of any electrical appliances around the pool should be in accordance with national regulations.
- Remove any means of access to and from the pool and store them out of reach of children whenever the pool is not in use.
- Use of accessories not approved by the pool manufacturer (including but not limited to ladders, covers, pumps, etc.) may result in personal injury and/or property damage.
- Irrespective of materials used for swimming pool construction, accessible surfaces have to be checked regularly to avoid personal injury.

LADDER (IF APPLICABLE)

- Check all nuts and bolts for tightness and tighten when required (if applicable).
- Maximum allowable weight: 150 kg (330 lbs).
- Ladder shall not be used for other purposes.

SAFETY CARE FOR CHILDREN

- Assign an adult to be responsible for watching children in the pool.
- Pool presents a drowning hazard even during filling and draining of the pool. Maintain constant supervision of children and do not remove any safety barriers until the pool is completely empty and stowed away.
- Children, especially younger than five years old, are at high risk of drowning. Drowning occurs silently and quickly and can occur in as little as 5 cm (2") of water.
- Keep children in your direct sight, stay close, and actively supervise them when they are in or near this pool and when you are filling and emptying this pool.
- When searching for a missing child, check the pool first, even if child is thought to be in the house.
- Do not leave toys inside the pool when finished using, since toys and similar items might attract a child to the pool. Position furniture (e.g. tables, chairs) away from pool, so that children cannot climb on it to gain access to the pool. After using pool, remove water to a level of 1 cm (0.5") or less.
- Locate pumps and filters in such a way that children cannot climb on them and gain access to the pool.

SWIMMING POOL AWARENESS

- Assembled by adults only; care should be taken when unpacking and assembling the pool; this pool may contain accessible potentially hazardous sharp edges or points that are necessary for the pool.
- The floor of the pool shall be visible at all times from the outside perimeter of the pool.
- Never allow horseplay, diving, or jumping into or around the pool. Serious injury, paralysis, or death could result when this rule is disregarded. DO NOT ALLOW anyone to swim alone without supervision.

NOTE: This pool has a maximum water fill level marked on the inside wall. Do not overfill; drain to proper level.

EMPTYING POOL: Push down on side wall and/or lift up one side of pool to empty pool water.

NOTE:

- Pool can be cleaned with mild soap and lukewarm water only.
- Make sure pool is completely dry before storing to help prevent mildew from forming.
- Store all parts in a dry heated area where temperatures do not go below 0°C (32°F).

WARNING

TO AVOID DANGER OF SUFFOCATION: Keep the plastic bag used in this product away from babies and children; do not use the bag in cribs, beds, carriage, or playpens. The plastic bag could block nose and mouth and prevent breathing. The plastic bag is not a toy.

- Only for domestic use.
- Place the product on a level surface at least 2 m (79") from any structure or obstruction such as a fence, garage, house, overhanging branches, laundry lines or electrical wires.
- One person needed to install the product.
- Installation time is around 15 to 45 minutes (excluding earthworks and filling).
- Prohibit running and lively games around the swimming pool.
- Always maintain clear, healthy water.
- Do not leave the drained pool outside. The empty pool is liable to become deformed and/or displaced due to wind.
- For outdoor use only.
- Never leave your child unattended – drowning hazard.
- Children can drown in very small amounts of water. Empty the pool when not in use.
- Do not install the paddling pool over concrete, asphalt or any other hard surface.
- Do not modify this product and/or use any parts and accessories not supplied by the manufacturer.

DIVING RISK

Do not dive into this pool. Diving into shallow water can result in a broken neck, paralysis, or death.

ELECTROCUTION RISK

- Keep all electrical lines, radios, speakers, and other electrical appliances away from the pool.
- Do not place pool near or under overhead electrical lines.

SPECIAL WARNING

- Local building codes may require obtaining a building or electrical permit. Users should follow regulations on setback, barriers, devices, and other conditions.
- DO NOT attempt to assemble this pool in extreme weather conditions, windy conditions, or when the temperature is below 16°C (60°F).
- This is a storable pool, which should be disassembled and stored when temperatures are expected to fall below 0°C (32°F).
- For filtration, the safety instructions shall indicate that the pool must not be used when the filtration system(s) is/are damaged (if applicable).

Ensure that you have an accessible telephone close to the pool so that you do not have to leave your children unattended while you phone. In the event of an accident:

- Remove the child from the water as quickly as possible;
- Immediately call the emergency services and follow the instructions they give you;
- Replace wet clothing with warm blankets;
- Memorise emergency phone numbers and display them near the swimming pool:
 - a. Fire brigade;
 - b. Emergency medical service;
 - c. Poison control centre.

As the pool owner, you are responsible for those persons who use your pool. Therefore:

- Never leave your children and other non-swimmers unattended in and around the pool;
- Ensure that the water is hygienically clean;
- Refresh your knowledge of first-aid measures at regular intervals;
- Store water treatment media out of the reach of children;
- Discuss the rules of conduct with your children prior to them using the swimming pool and explain the risks that can arise when around water once they are of a sufficient age;
- Contact your pool installer if you have any questions regarding safe use of the swimming pool.

The following items of equipment can provide additional pool safety. Your swimming pool specialist can advise you on:

- Safety cover;
- Fencing around the pool with a lockable gate;
- Pool alarm system;
- Enclosure.

The general safety information cannot account for all circumstances in individual cases. You are best aware of the swimming abilities and the conduct of your children and of other guests using your pool, as well as the site particulars. You should therefore employ further measures to ensure safety at the pool if necessary. Such measures may for example include additional supervisory persons if the pool is being used by a number of non-swimmers at the same time.

POOL MAINTENANCE

- Empty pool completely after each use and store the empty pool in such a way that it does not collect water from rain or any other source.
- After using pool, remove water to a level of 1 cm (0.5") or less.
- Carrying out checks and maintenance of the main parts every hour.
- These checks are not carried out the product could overturn or otherwise become a hazard.
- Check all nuts and bolts for tightness and tighten when required (if applicable).
- Check all coverings for bolts and sharp edges and replace when required (if applicable).
- Replace defective parts in accordance with the manufacturer's instructions.
- Change the water of product frequently (particularly in hot weather) or when noticeably contaminated.

Pool Safety Sign

Post This Warning Near Your Pool.



WARNING

NO DIVING OR JUMPING SHALLOW WATER

TO AVOID PERMANENT INJURY OR DEATH



- Watch children closely at all times.
- Be vigilant: Think safety and act safely at all times in and around water.
- No running or horseplay in and around pool; no jumping or diving into pool.
- Do not use pool when using alcohol or drugs.
- Do not use or allow glass in and around pool.

ALL POOL USERS, ESPECIALLY CHILDREN MUST LEARN AND FOLLOW THESE SAFETY RULES
TO AVOID HAZARDS IN AND AROUND WATER.

Pool Ladder Safety



WARNING

Always Remove and Securely Store the Ladder When the Pool Is Not In Use



Easy Steps To Remove the Pool Ladder:

1. Standing at the side of the ladder, grip at or near the top steps with both hands.
2. Tilt the ladder towards you. Once the ladder legs are above the pool wall, drag or lift the ladder out of the water.
3. Place the ladder on the ground.
4. Securely store the ladder away from the pool to prevent children using it to access the pool without supervision.

Pool Cover Safety

If you are going to use a pool cover, solar cover, or solar blanket, please read this information.

POOL COVER WARNING / SOLAR COVER WARNING / SOLAR BLANKET WARNING

WARNING:

AVOID DROWNING RISK

- Stay off cover – Will not support weight.
- Keep children away from cover. Children or objects cannot be seen under cover.
- Remove standing water. Child can drown on top of cover.
- Remove cover(s) completely before entry of bathers – Entrapment possible.
- Non-secured or improperly secured covers are a hazard.
- Failure to follow all instructions may result in injury or drowning.
- Pool cover (if included) is not a safety cover.
- Install pool cover with labels facing up.
- Use drawstring to secure pool cover to pool (if applicable).

NEVER LEAVE YOUNG CHILDREN UNATTENDED IN OR AROUND POOL COVER.

**This cover (if included) meets requirements described in specification ASTM F-1346.
Type OC cover classification.**

IMPORTANT: Do not use a pool cover, solar cover, or solar blanket on this pool if it does not have this type of warning label on the cover.

DANGER: Competent supervision and knowledge of the safety requirements are the only ways to prevent drowning or permanent injury in the use of this product! Never leave young children unattended.

Building Your Pool

Inside Your Product Box

The following illustration outlines the contents in your product box.

Items 2 – 5 are optional depending on the pool model you purchased.

1

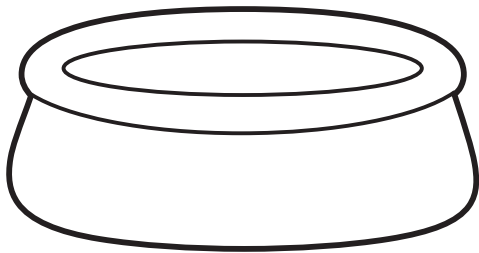

Pool Liner

2

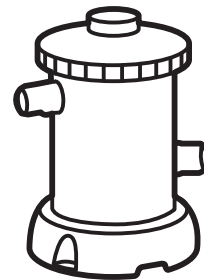

Cartridge Filter Pump

3

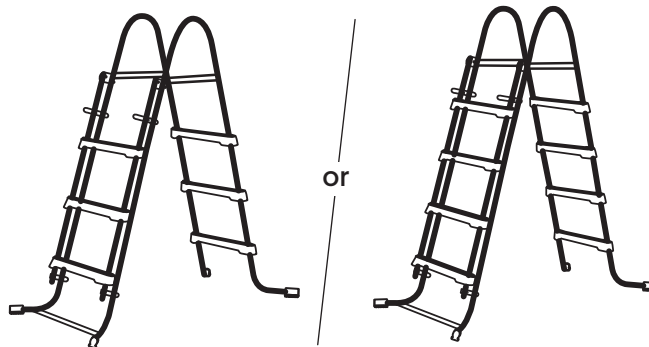

SureStep Ladder with Folding Steps

4



Pool Cover

5

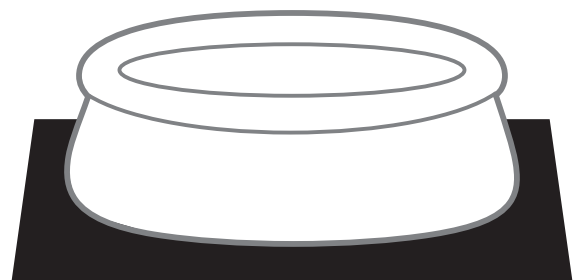

Ground Cloth

STEP 1: Prepare the Site

Before assembling your pool, check the contents and become familiar with all the parts. Review all the following warnings, guidelines and tips before proceeding with setup:

WARNINGS

- Do not overfill the pool and / or allow people to lay over or sit on pool wall – doing so can cause permanent injury!
- Drain pool to the proper level after a heavy rain. The Maximum Water Level FILL LINE is printed on the pool liner.
- Site must be level, stable, compacted soil.
- Do not install pool on a wooden deck or any type of wooden surface. You cannot use sand and/or uncompacted soil to provide a level surface for this pool; it will only wash out.

GUIDELINES

- The pool must be assembled on a smooth and level site of firm soil that is free of stones, gravel, sticks, blacktop, or other oil base compounds.
- Before setting up your pool, clear the area of hardy grasses. Certain types of vigorous grasses such as St. Augustine and Bermuda can grow through the liner. A ground cloth or tarp may be helpful in preventing this from occurring. Grass growing through the liner is not covered under warranty.
- Failure to follow all these instructions will cause pool to collapse and will void the warranty!

TIP: It will be much easier to install your pool if you unfold it and let it lay in direct sunlight for about 2 hours prior to installation. This will help to ensure a wrinkle-free fit because the pool material will be more pliable allowing it to form into shape during installation.

GETTING STARTED

- Contact your local utilities, checking that no underground cables, telephone lines, gas lines, etc. run beneath the area you have selected.

STEP 2: Lay out the Liner

1. Carefully unfold the QuickSet pool and inspect the seams for manufacturing defects.
2. With the inflatable ring on the top side, and safety content on the outside, lay out the pool in the area selected, making sure the bottom of the pool is both flat and round.
3. If your pool included openings or you are going to purchase a filter pump system, position the Suction & Return fitting locations so they are 10 to 21 feet from the electrical outlet you plan to use for the pool pump.

STEP 3: Inflate the Top Ring

1. Locate a clean area free of stones or other sharp objects to inflate the pool.
2. Inflate the air chambers following the numbered sequence (if any) slowly with a manual/foot air pump.

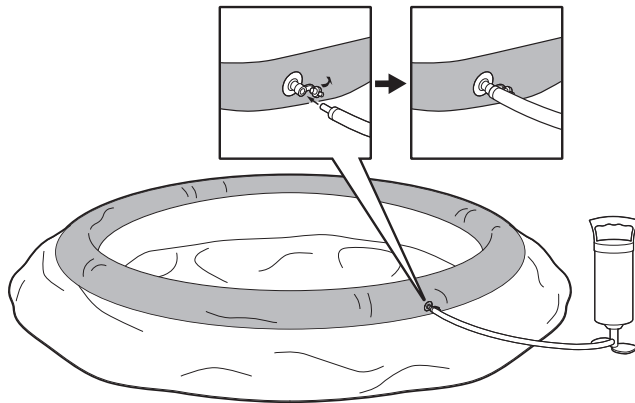

Caution: Avoid wearing shoes when stepping on the pool liner. Only use hands or bare feet to open up the liner.

3. The adequate air pressure: make sure the pool is firm to the touch but not hard – there should be small folds around the armrests, backrests and/or side edges, and below the cup holders (if any). Also compare the pressure with that of the large main chamber.
4. Close and press the inflation valves into the unit to get a flat surface.
5. Check regularly to ensure the adequate air pressure during each use, especially on very hot or cold days.

CAUTION: Inflate by adult only. Do not overinflate, use high pressure air compressor to inflate, or exceed the recommended Design Working Pressure. Inflate with cold air only.

STEP 4: Install the Fittings for Filter Pump

If your pool came with fittings, install both the Suction and Return fittings to the pool wall before filling the pool.

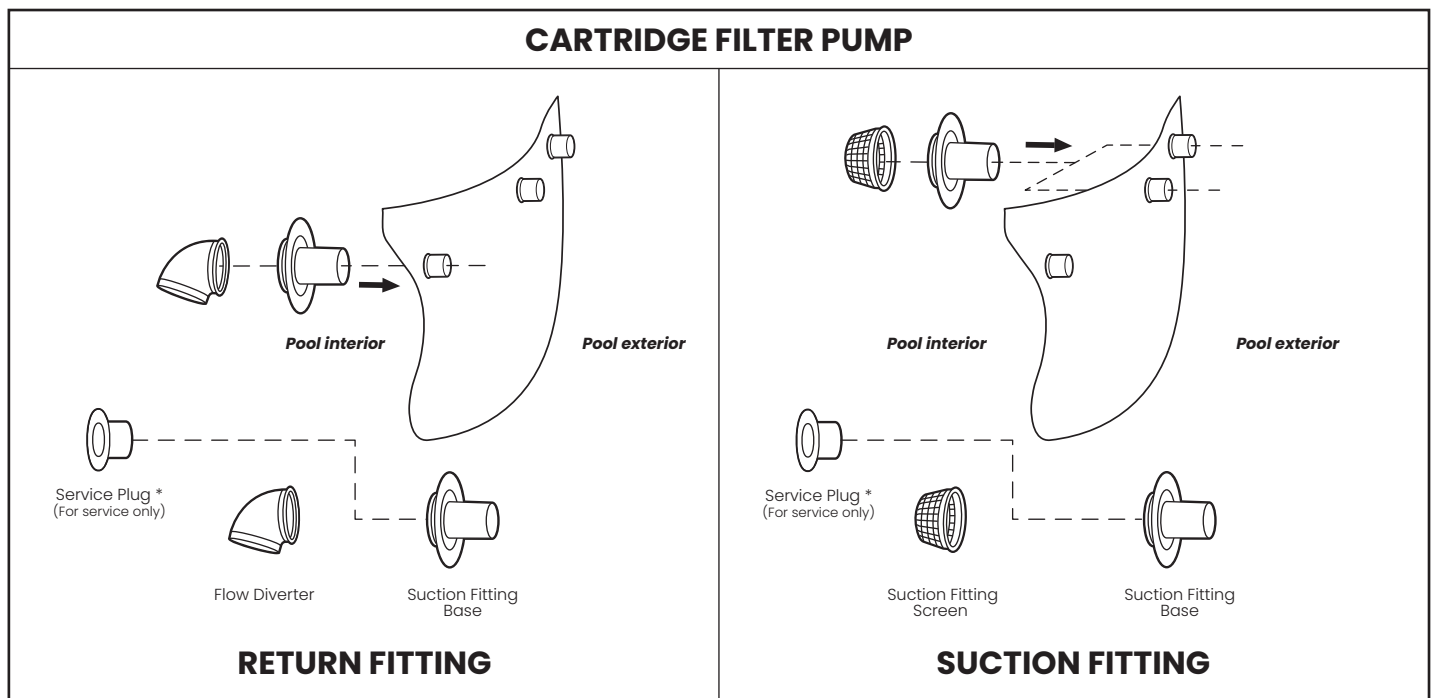

NOTES:

- The black rubber Gasket should always be slid over the threaded plastic suction or return fitting and be on the pool interior before the fitting is placed through the pool wall to make a watertight connection.
- Make sure to cover the suction and return fittings with the Water Cap and/or the Service Plug (if included) while you fill your pool, or until you are ready to add a filtration system.
- * DO NOT cover the suction and return fittings with any Water Cap or Service Plug when the filtration system is in operation. Only use the Water Cap and/or the Service Plug (if included) when replacing cartridge filter or servicing the filter pump.

Filling Your Pool

1. Fill the pool with 2.54cm of water.
2. Smooth out the wrinkles from the bottom of the pool by brushing outwards from the inside of the pool so it fills up evenly. Make sure that the base of the pool is completely flat and leveled.
IMPORTANT: Not following this step will make the pool fill unevenly and may look misshapen. If the pool is uneven, you may need to restart the setup.
3. Pull all the outer walls up straight and make sure they are not under the pool floor. Also make sure to pull up the top ring, all around the pool, so that it fills evenly.

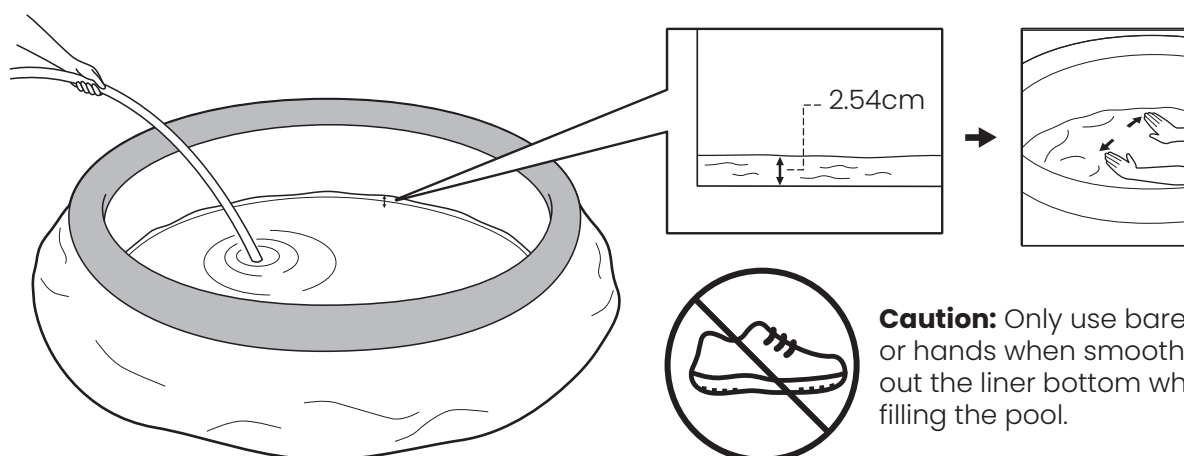

NOTES:

- If more than 2.54-5.08cm of water collects on any one side before the pool starts filling in the center, the pool is not level enough, and must be corrected (See Section "Prepare the Site").
 - The weight of the water will make adjustment impossible after this point.
4. If your pool includes a filtration system, install it as per the enclosed "Funsicle Filter Pump User Guide".

5. Now, as you continue filling, the inflated ring will rise as the water deepens. Continue adding water to your pool up to the "FILL LINE" printed on the interior of your pool.

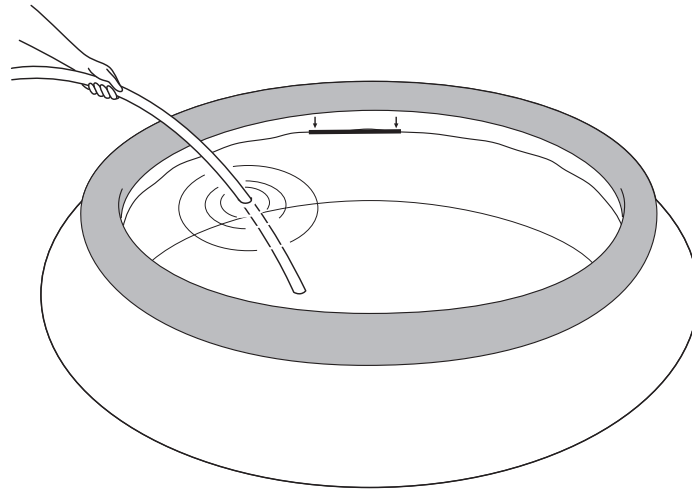

CAUTION: Always follow the chemical manufacturer's directions, and the health and hazard warnings.

Do not add chemicals while the pool is occupied. This can cause skin or eye irritation. Concentrated chlorine solutions can damage the pool liner. In no event is Polygroup, our buyer/retailers, or any other party liable for costs associated with the loss of pool water, chemicals, or water damage. Keep spare filter cartridges on hand. Replace cartridges every two weeks. We recommend the use of Funsicle Filter Pumps with all of our above ground pools. To purchase a Funsicle Filter Pump or other accessories, visit our website at funsicle.com or call Customer Service.

Excessive Rain: To avoid damage to the pool and overfilling, immediately drain rain water that causes the water level to be higher than the FILL LINE.

Connecting to Water Hose

If the pool is equipped with a Hose Connector, follow the steps as below to activate the water sprayer.

Tighten the Quick-Connect mechanism between the Threaded Water Hose Connector and the standard garden hose.

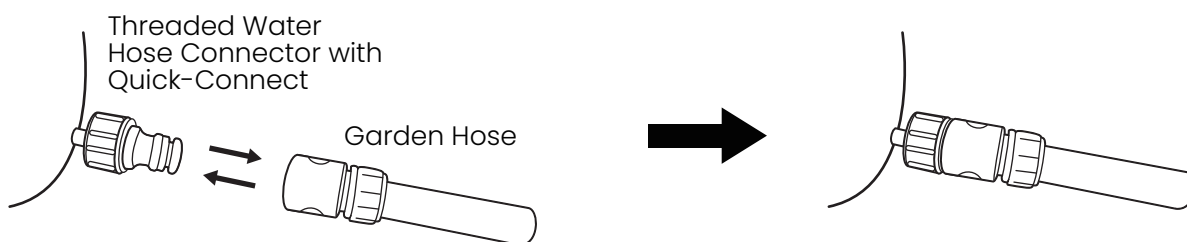

Turn the water on slowly, and adjust to your desired spraying pressure by rotating the tap (if applicable).

Draining & Dismantling Your Pool

1. Check local regulations for specific directions regarding disposal of swimming pool water.
2. Remove the protective foam ring on the drainage cap.
3. Follow the steps below for water drainage:

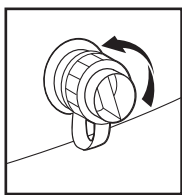

a) Turn the drain cap counterclockwise

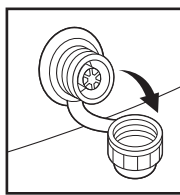

b) Return the drain cap from the valve

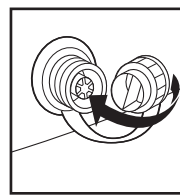

c) Flip the drain cap and reinsert it into the drain valve

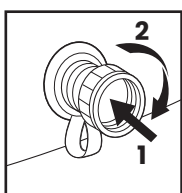

d) Push and turn the drain cap clockwise for about a quarter turn (90°) to unlock

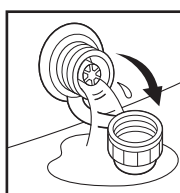

e) The drain valve is now open, and water will begin to flow out

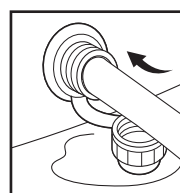

f) Attach a 1.6cm garden hose to the drain valve

4. Place the other end of the garden hose in an area where the water can be safely drained away from the house and other nearby structures.
5. When the water stops draining, start lifting the pool from the side opposite to the drain valve to drain any remaining water and empty the pool completely.
6. After drainage, lock the drain valve and close the drain cap.

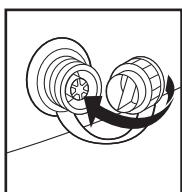

a) Flip the drain cap and reinsert it into the drain valve

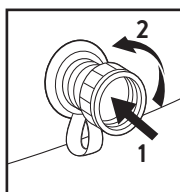

b) Push and turn the drain cap counterclockwise for about a quarter turn (90°) to lock

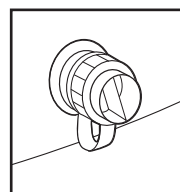

c) Close the drain cap

NOTE: NEVER step on the drain valve.

Maintaining Your Pool

Storage

1. Deflate the top ring completely and remove all connecting parts (if there are any).
2. Be sure that the pool and all parts are completely dry before storage. Air dry the liner in the sun until it is completely dry before folding (see *drawing 1*). Sprinkle some talcum powder to prevent the vinyl from sticking together and to absorb any residual moisture.
3. Create a square shape. Starting at one side, fold one-sixth of liner into itself twice. Do the same on the opposite side (see *drawings 2 & 3*).
4. Once you have created two opposing folded sides, simply fold one over the other like closing a book (see *drawings 4 & 5*).
5. Fold the two long ends to the middle (see *drawing 6*).
6. Fold one over the other like closing a book, and finally compact the liner (see *drawing 7*).
7. Store the liner and accessories in a dry, temperature-controlled storage location above 32°F (0°C) and below 104°F (40°C).

TIP: The original packaging can be used for storage.

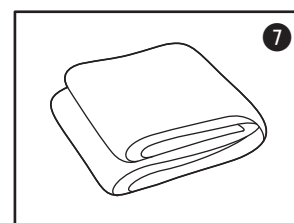
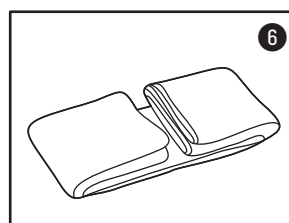
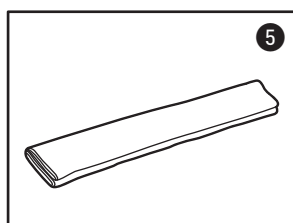
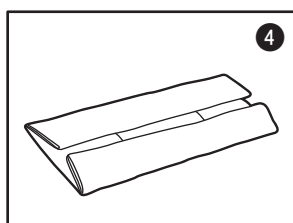
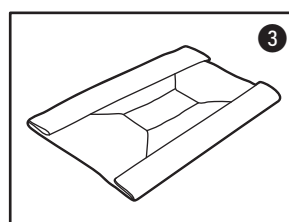
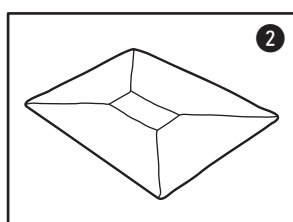
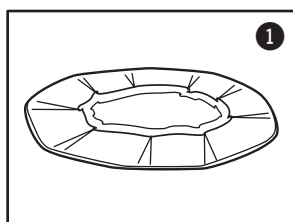

Repair

To repair a puncture on the pool, follow these steps:

1. Locate the puncture on the pool.
2. While standing in the pool, peel off and apply the patch over the puncture on the interior pool wall. This patch can also be used to repair puncture on the top ring of the pool.
3. Press and rub the patch firmly with your fingers to release any trapped air bubbles.
4. Flatten the patch until it is completely smooth.

NOTE: Scan this QR code to watch the demonstration video.



Winterizing

This above ground pool cannot be winterized and must be drained, disassembled, and properly stored if you live in an area where the temperature drops below 32°F (0°C). If you are in a warmer environment, follow the instructions below.

After usage, you can easily empty and store away your pool in a safe place (see long term storage above). Some pool owners, in warmer climates however, may choose to leave their pool up all year round. In cold areas, where freezing temperatures occur, there can be a risk of ice damage to your pool. Leaving your above ground pool set up in areas where the temperature drops below 32 degrees Fahrenheit (0 Celsius) voids the warranty.

1. Clean the pool water thoroughly.
2. Remove the skimmer (if applicable) or any accessories attached to the threaded strainer connector. Replace strainer grid if necessary. Be sure all accessories parts are clean and completely dry before storage.
3. Unplug the Inlet and Outlet fitting from the inside of the pool (if applicable).
4. Remove the ladder (if applicable) and store in a safe place. Be sure the ladder is completely dry before storage.
5. Remove the hoses that connect the pump and filter to the pool.
6. Add the appropriate chemicals for the winter period. Consult your local pool dealer as to which chemicals you should use and how to use them. This can vary greatly by region.
7. Cover pool with Pool Cover.
IMPORTANT: Pool Cover is not a Safety Cover.
8. Clean and drain the pump, filter housing, and hoses. Remove and discard the old filter cartridge. Keep a spare cartridge for the next season.
9. Bring pump and filter parts indoors and store in a safe and dry area, preferably between 0°C (32°F) and 40°C (104°F).

Using Your 3D Goggles

Safety Guidelines

WARNINGS:

- Only use under supervision.
- Never pull goggles away from face, as they may spring back and cause eye damage.
- Do not leave child unattended with product while in use.
- Avoid scratching the goggles' lens.
- DO NOT dive into the water wearing goggles.
- The product is not a life-saving device.
- The product must be assembled/disassembled by an adult.
- Keep the assembly and installation instructions for further reference.
- Goggles are for children only.
- Keep the product away from fire.
- These goggles are not to be used for surface swimming.
- Not to use outside the pool.

Use & Care

To be able to see 3D effects, you must wear the 3D Goggles.

Wearing the Goggles:

1. Remove the protective film from the goggles' lens before use.
2. Adjust the goggles' head strap and bridge strap to a proper and comfortable position.
 - The head strap is used to hold the goggles in place.
 - Making the strap tighter is not necessarily better, as this may cause discomfort and markings around the eyes.
 - Correct adjustment can be obtained by adjusting the band until a comfortable fit is achieved.
 - Correct adjustment of the bridge strap is essential for both comfort and a watertight seal.
3. To avoid water entering the lens, slide the left and right lens closer together or further apart with one notch at a time until the correct fit is obtained.



4. To clear water or to adjust the goggles, take a firm grip on the goggles' lens and tilt the lower edge of the goggles' lens slightly away from the face.
5. To remove the goggles, put your hand under the strap at side of your head. Slide your thumbs to the back of your head and lift the elastic from the back to the front of your head.

NOTE: It is recommended that teachers, coaches, or mature swimmers demonstrate this method to young children.

Care Instructions:

1. Rinse the goggles with cold clean water before storage.
2. Air-dry the goggles and store it in a dry place. Do not store it under direct sunlight.

[This page is intentionally left blank.]

[This page is intentionally left blank.]

Dear Customer,

Thank YOU for choosing one of our Funsicle products. We're on a mission to inspire the world to play more outdoors, which is why we design products that capture the summertime spirit of imagination, connection and fun.

It's important to us that you have the BEST experience with this product, and we're excited for you to make some happy outdoor memories.

Once again, we thank you for placing your trust in us. Happy swimming and playing!

- Your friends, the Funsicle Team

CONTACT US

We are here to help! For FAQ, troubleshooting tips, warranty or replacement parts, contact us using the number or email available for your region.

CUSTOMER SERVICE

United Kingdom

Phone: +44 (0) 330 090 4414

Email: support@poly-group.co.uk

France

Website: www.polypool.fr

Email: aide@polypool.fr

Spain

Website: www.polypool.es

Email: apoyo@polypool.es

Italy

Phone: +39 (0) 332 730 083

Email: info@globalfar.com

Germany

Phone: +49 (0) 621 845 5210

Email: service@rms-gruppe.de

Netherlands

Phone: +31 (0) 88 002 06 55

Email: service@poly-group.nl

Bulgaria

Email: service.polygroupbg@gmail.com

Greece

Phone: +30 210 6831030

Email: info@homeandcamp.gr

Hungary

Email: sales@globalbrandscee.com

Romania

Phone: +40 726 473955

Email: polygroupservice.ro@gmail.com

Russia

Phone: +381 (0) 637 137 822

Email: polygroupsrbija@gmail.com

Denmark

Email: polygroup@maxtoys.dk

Australia

Phone: +61 1800 955 817

Email: info@toyallianceleisure.com.au

New Zealand

Phone: +64 (0) 800 440 017

Email: info@toyallianceleisure.co.nz

Funsicle®

Polygroup Pacific Limited
Unit 606, 6th Floor, Fairmont House,
8 Cotton Tree Drive, Central, Hong Kong.